



Chick-fil-A



SOUTH ELEVATION



EAST ELEVATION



NORTH ELEVATION



WEST ELEVATION



PRELIMINARY ELEVATIONS
Spanish Fork, UT

File Name: 10217-ALL-01-A1 10-17-14



Note:
All roof top mechanical equipment shall be located in
equipment yard and screened from view by parapet walls.

COLOR AND MATERIAL LEGEND

- 101 Paint - Sherwin Williams - #000041 "Orchard Gray"
- 102 Paint - Sherwin Williams - #000164 "Studio Black"
- 103 Paint - Sherwin Williams - #001000 "Vibrant Blue"
- 104 Stone Veneer - Colorado Stone Products "Crestedgate"
- 105 Metal Canopy - Color "Metal Black"
- 106 Precast Concrete - Precast Innovations, Inc. - Color Sage

C · R · H · O
ARCHITECTURAL RENDERING
100 SOUTH 100 WEST SUITE 200
SALT LAKE CITY, UT 84115
313.467.1000
WWW.CRHOCORP.COM

PRELIMINARY SITE PLAN
1" = 30'-0"

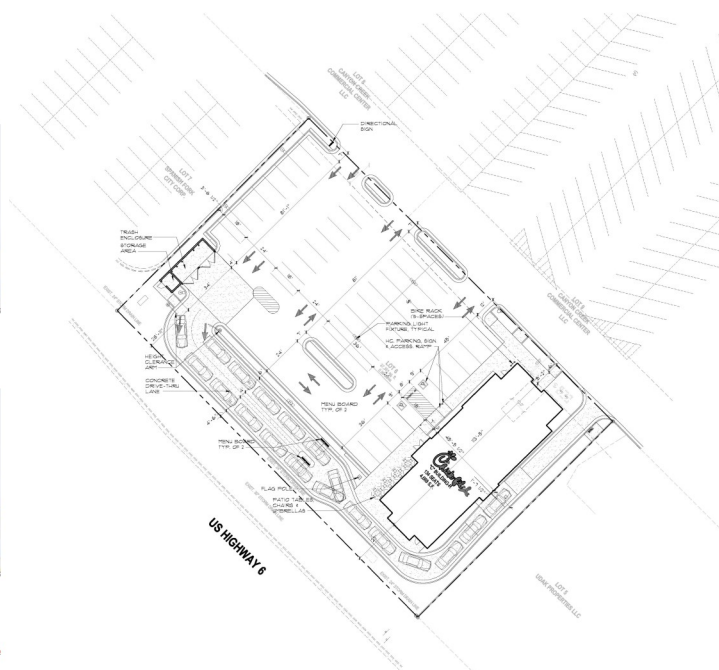

5200 Buffington Rd.
Norcross, Georgia, 30349-2908

Developer:
Mark Date By

Mark Date By

Mark Date By

Mark Date By

Mark Date By

Mark Date By

Mark Date By

Mark Date By

Mark Date By

Mark Date By

Mark Date By

Mark Date By

Mark Date By

Mark Date By

Mark Date By

Mark Date By

Mark Date By

Mark Date By

Mark Date By

Mark Date By

Mark Date By

Mark Date By

Mark Date By

Mark Date By

Mark Date By

Mark Date By

Mark Date By

Mark Date By

File Name: Chick-fil-A

Applicant: Ryan Robinson

Number of Lots: Not Applicable

Address: 825 East Highway 6

Application Date: 10/20/2014

Site Plan Application

0.875 Acres

File #: 14-000827

Permit #: SP14-000015

Application Approved: 12/10/2014